

Firestopping

GENERAL

FIRESTOPPING SHALL BE INSTALLED AT ALL PENETRATIONS THROUGH FIRE RATED FLOOR, WALL AND ROOF / CEILING ASSEMBLIES BY MECHANICAL, PLUMBING AND ELECTRICAL PIPES, TUBES, CONDUITS, ETC., IN ACCORDANCE WITH THE INTERNATIONAL BUILDING CODE REQUIREMENTS. THROUGH-PENETRATION SYSTEMS SHALL BE PROVIDED AND INSTALLED AS SPECIFIED BELOW:

GYPSUM BOARD WALLS

METAL PIPE

U.L. DES. NO. W-L-1001 - UP TO 4 HOUR FIRE RATING F-RATING = 4, T-RATING = 4

COMPONENTS:

1. FIRE STOP CAULK OR PUTTY EACH SIDE OF PENETRATION

PLASTIC PIPE

U.L. DES. NO. W-L-2003 - UP TO 2 HOUR FIRE RATING F-RATING = 2, T-RATING = 2

COMPONENTS:

1. FIRE STOP WRAPPING MATERIAL AROUND PIPE
2. FIRE STOP CAULK OR PUTTY EACH SIDE OF PENETRATION

FLOORS - PLYWOOD OVER WOOD JOIST

METAL PIPE

U.L. DES. NO. F-C-1002 - 2 HOUR FIRE RATING F-RATING = 1, T-RATING = 1

COMPONENTS:

1. FIRE STOP CAULK APPLIED WITHIN THE ANNULUS ON EACH SIDE OF THE PENETRATION

PLASTIC PIPE

U.L. DES. NO. F-C-2044 - UP TO 2 HOUR FIRE RATING F-RATING = 2, T-RATING = 1

COMPONENTS:

1. WRAP STRIP
2. SEALANT APPLIED WITHIN THE ANNULUS ON EACH SIDE OF THE PENETRATION

ROOFS - WOOD ROOF DECK OVER WOOD BAR JOISTS & GYPSUM BOARD CEILING

METAL PIPE

U.L. DES. NO. F-C-1006 - UP TO 1 HOUR FIRE RATING F-RATING = 1, T-RATING = 1

COMPONENTS:

1. PROVIDE FIRE STOP CAULK AROUND PENETRATIONS THROUGH GYPSUM BOARD CEILING & METAL ROOF DECK

PLASTIC PIPE

U.L. DES. NO. F-C-2024 - UP TO 2 HOUR FIRE RATING F-RATING = 2, T-RATING = 2

COMPONENTS:

- PROVIDE THE FOLLOWING COMPONENTS AT THE BOTTOM OF GYPSUM BOARD CEILING & AT UNDERSIDE OF ROOF DECK:

1. FIRE-RESTRICTING METAL COLLAR FASTENED TO UNDERSIDE OF GYPSUM BOARD CEILING.
2. FIRE STOP CAULK OR MOLDABLE PUTTY AROUND ANNULAR SPACE AT UNDERSIDE OF STEEL ROOF DECK.

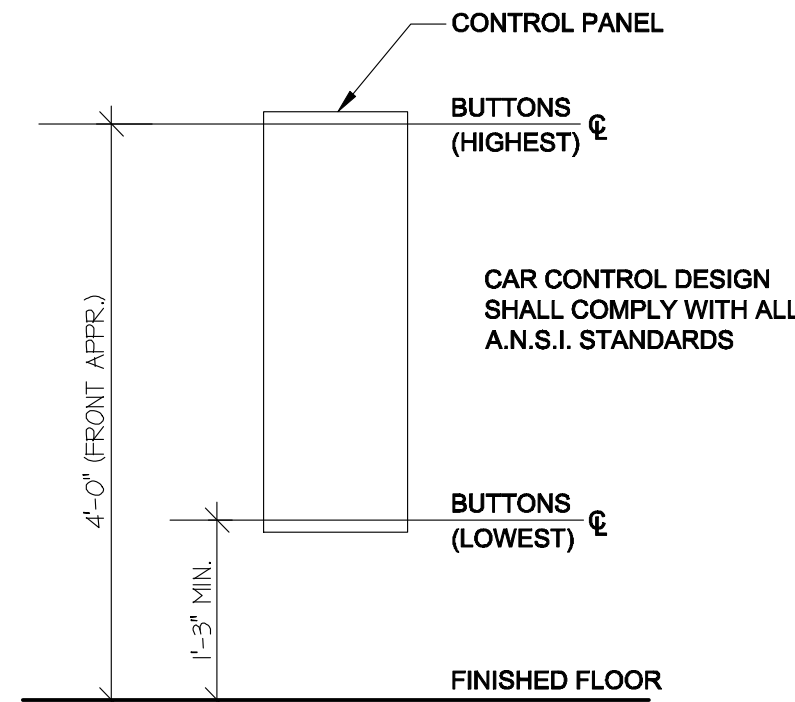

C CAR CONTROL PANEL HEIGHT

SCALE 3/4" = 1'-0"

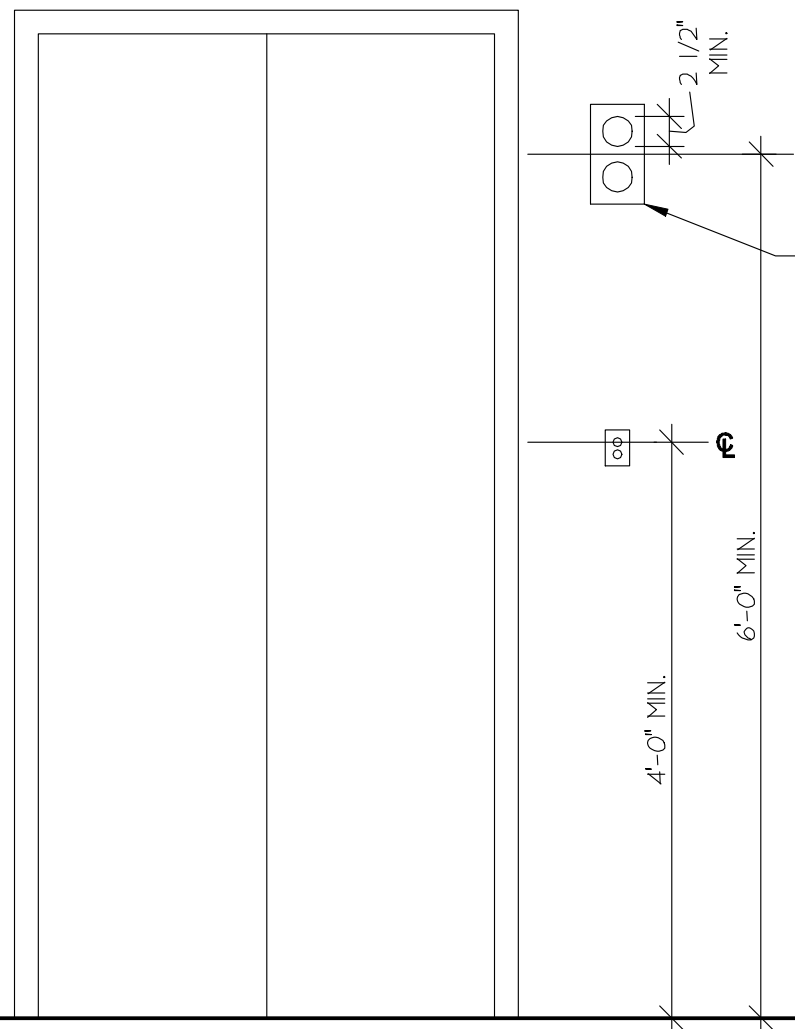

B ELEVATOR ENTRANCE DETAIL

SCALE 3/4" = 1'-0"

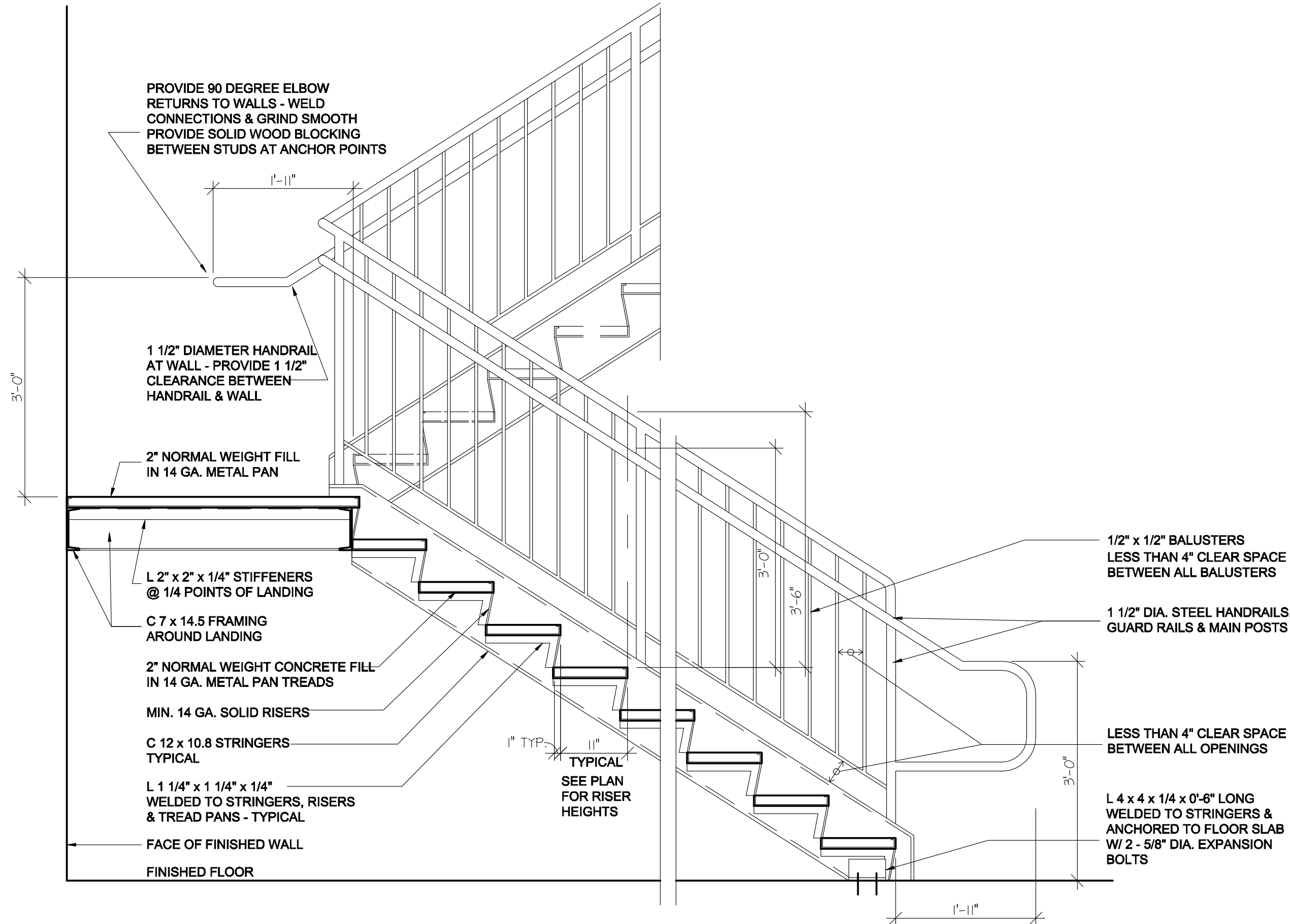

A TYPICAL STAIR SECTION

SCALE 3/4" = 1'-0"

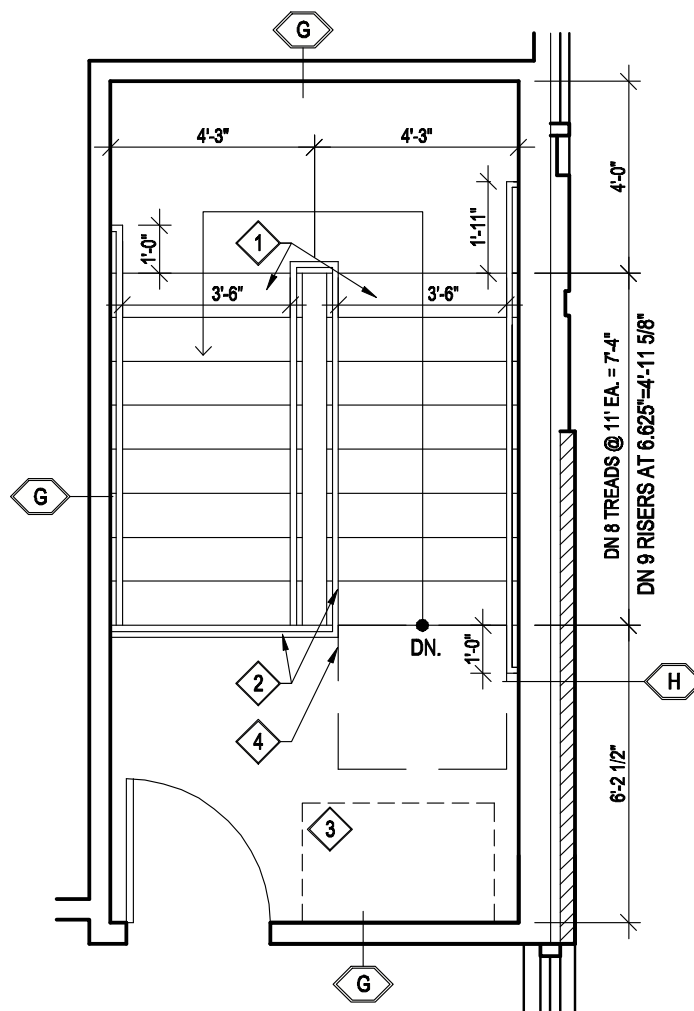

3 3rd FL00R STAIR 1

SCALE 1/4" = 1'-0"

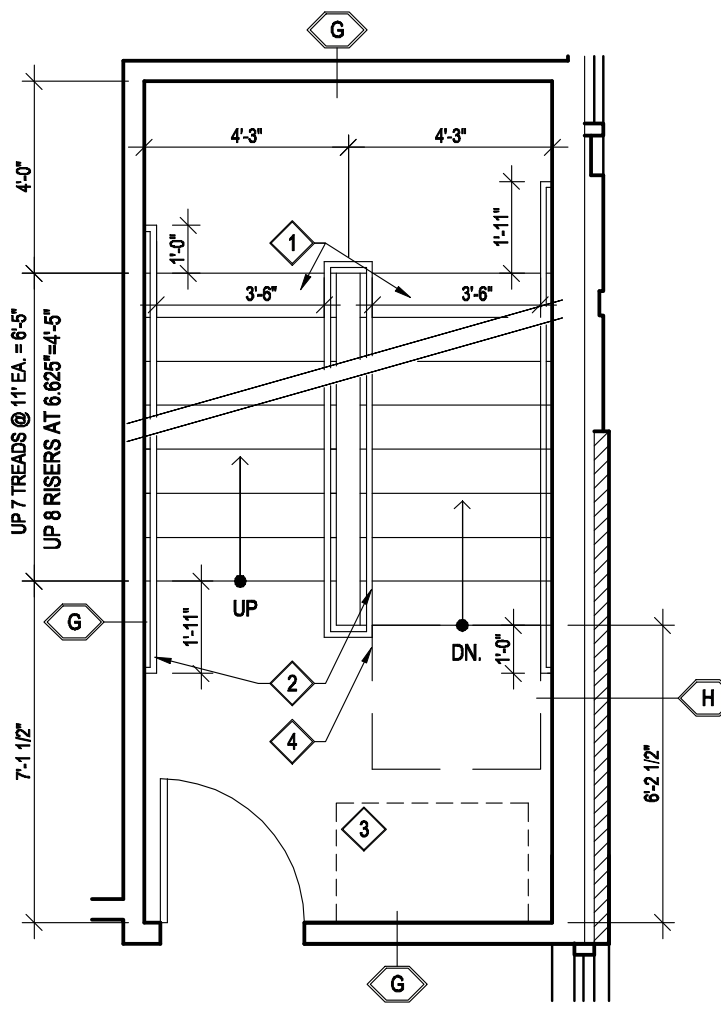

2 2nd FL00R STAIR 1

SCALE 1/4" = 1'-0"

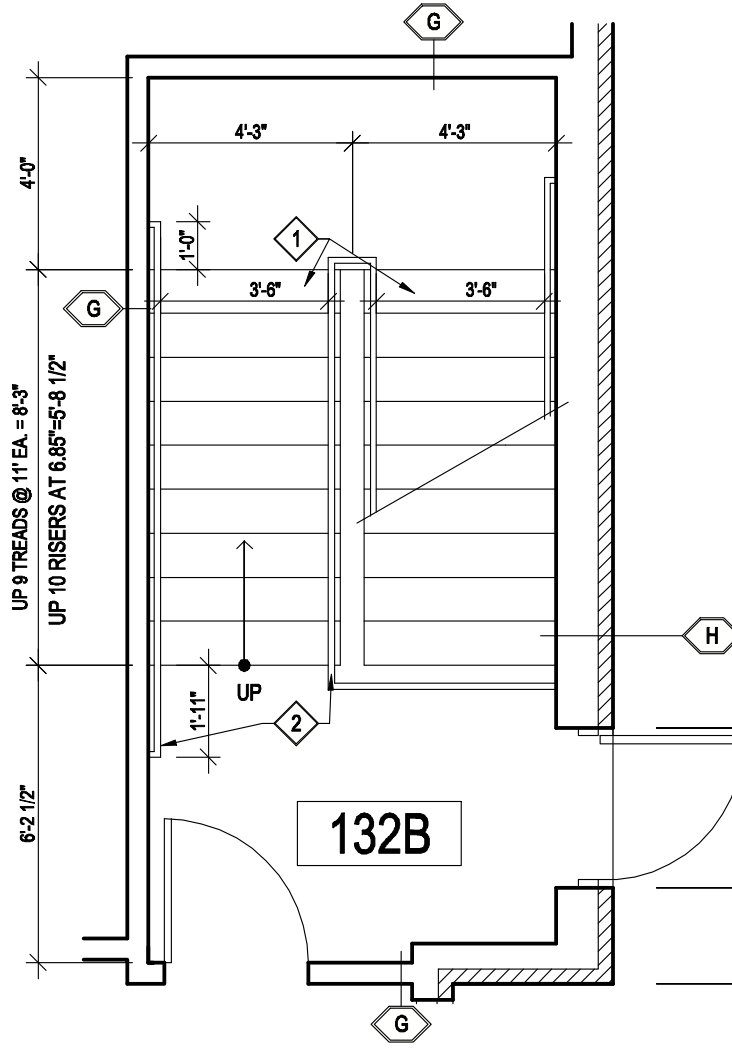

1 1st FL00R STAIR 1

SCALE 1/4" = 1'-0"

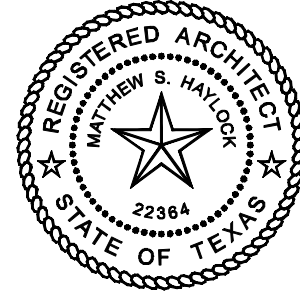

2/4/11

Stair Notes

- STAIRS**
MATERIAL: CONCRETE-FILLED, METAL PAN
EXPOSED TREADS SHALL HAVE NON-SLIP SURFACES COMPLYING WITH APPLICABLE A.N.S.I. & A.D.A. STANDARDS
STAIRS & LANDINGS SHALL BE CAPABLE OF WITHSTANDING A UNIFORM LOAD OF 100 P.S.F.
CLEAR WIDTH OF STAIRS BETWEEN STRINGERS SHALL BE MINIMUM 3'-8"
- STEEL HANDRAIL or GUARDRAIL**
HANDRAILS: 1 1/2" DIA. HANDRAILS EACH SIDE OF STAIR. T/ HANDRAILS @ 34" ABOVE NOSING.
GUARDRAILS: 1 1/2" DIA. GUARDRAIL CONTINUOUSLY EXTENDED FROM HANDRAIL. T/ GUARDRAILS @ 42" A.F.F.
BALUSTERS: LESS THAN 4" CLEAR SPACE BETWEEN ALL BALUSTERS AND ALL OTHER OPENINGS.
TUBING: COLD-ROLLED STRUCTURAL STEEL.
PIPING: STANDARD WEIGHT, SCHEDULE 40
TOP RAILS SHALL BE CAPABLE OF WITHSTANDING A CONCENTRATED LOAD OF 200 POUNDS IN ANY DIRECTION, A 300 LB. CONCENTRATED LOAD APPLIED OVER 4 SQ. INCHES, & A UNIFORM OF 50 P.S.F. HORIZ. & 100 P.S.F. VERT.
BALUSTERS SHALL BE CAPABLE OF WITHSTANDING A A HORIZONTALLY APPLIED LOAD OF 50 POUNDS, NOT TO EXCEED 1 S.F. INCLUDING SPACES ALONG THE BALUSTERS.
- AREA OF REFUGE - MINIMUM 2'-6"x4'-0" CLEAR FLOOR AREA**
NO PIPES OR FIXTURES SHALL BE INSTALLED WITHIN THIS AREA
- PROVIDE DETECTABLE WARNING 36" DEEP AT THE TOP OF ALL STAIR RUNS**

Partition & Wall Keys

REFER TO SHEET A6.1 FOR COMPLETE CONSTRUCTION DETAILS & COMPONENTS.

- 1 HOUR FIRE RATED - 5 1/4" INTERIOR PARTITION. MECHANICAL ROOMS, STORAGE ROOMS, & GUESTROOM DEMISING
- 2 HOUR FIRE RATED - 5 1/4" INTERIOR PARTITION. ELEVATOR SHAFT & FAN ROOM
- 1 HOUR FIRE RATED - 7 1/4" INTERIOR PARTITION. PLUMBING WALL
- NOT RATED - 4 3/4" INTERIOR PARTITION. GUESTROOM BATHROOM (WITHIN GUESTROOMS)
- 2 HOUR FIRE RATED - 3 1/2" INTERIOR PARTITION. TOILET EXHAUST SHAFT, LINEN CHUTE, & DRYER VENT SHAFT
- 1 HOUR FIRE RATED - 4 3/4" INTERIOR PARTITION. CORRIDOR WALLS
- 1 HOUR FIRE RATED - 4 3/4" INTERIOR PARTITION. DRAFT STOP & STAIR ENCLOSURE
- 1 HOUR FIRE RATED - 4 3/4" INTERIOR PARTITION. EXTERIOR WALLS

Light & Ventilation Schedule

UNIT	ROOM	AREA (S.F.)	ORINANCE REQUIRED (S.F.)			ACTUAL PROVIDED (S.F.)		
			NATURAL LIGHT	NATURAL VENT	MECH. EXHAUST	NATURAL LIGHT	NATURAL VENT	MECH. EXHAUST
ACC K	SLEEPING	242	19.36	9.88	-	19.45	10.95	-
	BATH	50	N.R.	0.0	35 CFM	0.0	0.0	00 CFM
ACC DQ	SLEEPING	274	21.92	10.96	-	23.78	13.20	-
	BATH	50	N.R.	0.0	35 CFM	0.0	0.0	00 CFM
K	SLEEPING	217	17.36	8.68	-	19.45	10.95	-
	BATH	36	N.R.	0.0	35 CFM	0.0	0.0	00 CFM
DQ	SLEEPING	217	17.36	8.68	-	19.45	10.95	-
	BATH	36	N.R.	0.0	35 CFM	0.0	0.0	00 CFM
ACC K	SLEEPING	346	27.68	13.84	-	32.28	17.7	-
SUITE	BATH	50	N.R.	0.0	35 CFM	0.0	0.0	00 CFM
ACC DQ	SLEEPING	346	27.68	13.84	-	32.28	17.7	-
SUITE	BATH	50	N.R.	0.0	35 CFM	0.0	0.0	00 CFM
DQ	SLEEPING	287	22.96	11.48	-	23.78	13.20	-
SUITE	BATH	36	N.R.	0.0	35 CFM	0.0	0.0	00 CFM

© COPYRIGHT HAYLOCK DESIGN, INC.
REPRODUCTION OF THE MATERIAL HEREIN, IN PART OR IN WHOLE, WITHOUT WRITTEN CONSENT OF HAYLOCK DESIGN, INC., IS IN VIOLATION OF THE COPYRIGHT LAWS OF THE UNITED STATES AND WILL BE SUBJECT TO LEGAL PROSECUTIONS.

HAYLOCK DESIGN, Inc.
Architects + Designers
1800 Nations Drive
Suite 201
Gurnee, Illinois 60031
Phone 847-396-8800
Fax 847-396-8836
© 2011

15707 Oak Grove Blvd.
Lakeway, Texas 78734

Holiday Inn Express

DATE

FOR PERMIT
2-4-11

1003

A6.2